

OCEAN CITY'S "ANGELENO" REELS NOS. 988, 990 AND 936  
(Model B)

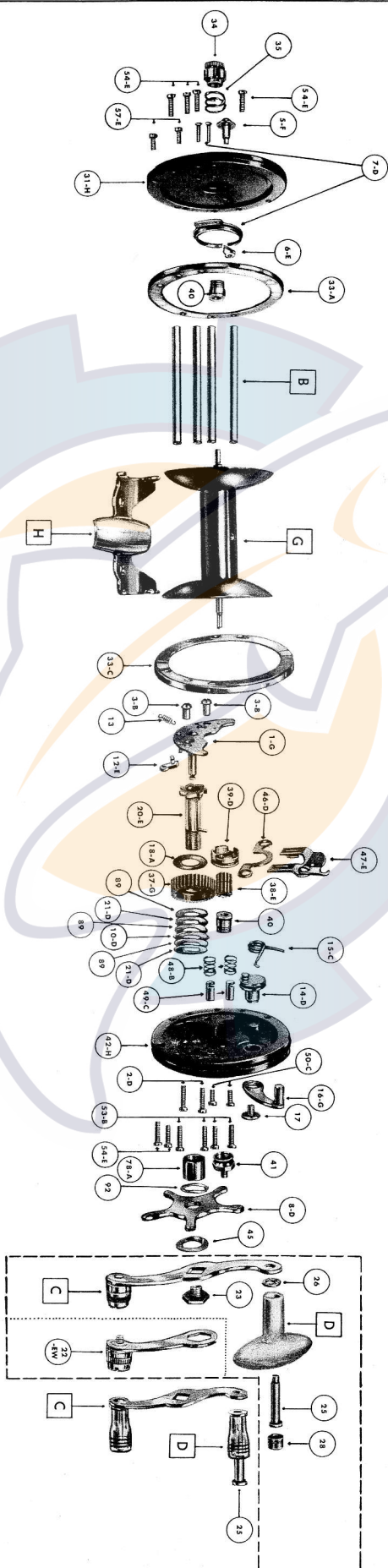

**HOW TO ORDER PARTS FOR YOUR REEL**—Locate the part desired in the illustration above and note part number. When ordering, state quantity, part number, part name and model letter which you will find on underside of reel stand. Enclose money order, stamps or check. Our minimum charge for one order is \$3.25; please add \$.15 on each order for return postage and insurance.

PART No.	PART NAME	PRICE	PART No.	PART NAME	PRICE	PART No.	PART NAME	PRICE	PART No.	PART NAME	PRICE
1-G	Bridge	.30	15-C	Eccentric Spring	.12	28	Handle Knob Oiler (for Model Nos. 936 & 990)	.24	41	Right Side Adjusting Cap	.12
2-D	Bridge Screw	.02	16-G	Free Spool Lever	.24	23	Handle Screw	.16	44-Q	Spool (for Model No. 988)	1.00
3-B	Bridge Screw Nut	.04	17	Free Spool Lever Screw	.05	31-H	Left Side Plate (with Part Nos. 5-F, 6-E, & 7-D)	.50	44-V	Spool (for Model No. 990)	1.50
5-F	Click Button	.12	19-H	Frame Post (for No. 988 only)	.12	34	Left Side Oil Cap Ring	.32	44-U	Spool (for Model No. 936)	1.96
6-E	Click Pawl	.08	19-I	Frame Post (for No. 990 only)	.12	33-A	Left Side Oil Cap Ring	.32	43-R	Stand (for Model No. 988)	.60
7-D	Click Spring & Rivets	.14	19-K	Frame Post (for No. 936 only)	.14	35	Left Side Oil Cap Spring	.04	43-M	Stand (for Model No. 990)	.60
12-E	Drag Dog	.10	20-E	Gear Sleeve & Lock Pin	.60	40	Left & Right Side Bearing	.75	53-B	Screw, Right Side Plate	.02
13	Drag Dog Spring	.03	78-A	Gear Sleeve Bushing	.08	37-G	Main Gear	.20	54-E	Screw, Left Side Plate	.02
18-A	Drag Fiber Washer	.01	24-D	Handle Knob (for Model No. 988)	.14	38-E	Pinion Gear	.30	57-E	Screw, Left Side Stand	.28
89	Drag Laminated Washer	.02	24-C	Handle Knob (for Model No. 936 & 990)	.24	39-D	Pinion Gear Clutch	.26	46-D	Yoke Plate	.16
21-D	Drag Lock Washer	.05	25	Handle Knob Rivet (for Model Nos. 988, 990, 936)	.06	42-H	Right Side Plate (Specify Model No. of Reel)	.50	48-B	Yoke Spring	.04
92	Drag Eared Washer	.05	26	Handle Knob Rivet (for Model No. 936 & 990)	.01	33-C	Right Side Plate Ring	.32	49-C	Yoke Guide Stud	.06
10-D	Drag Star Bottom Washer	.04							50-C	Yoke Guide Stud Screw	.02
45	Drag Star Top Washer	.32							22-EW	Handle Wrench Only	.30
8-D	Drag Star	.50									
14-D	Eccentric										

Handles Listed Below are Interchangeable on Models 988-990-936

22-H	Handle Complete with part No. 24-D (Handle Knob) and No. 25 (Handle Knob Rivets) Standard on Model No. 988	.80
22-E	Handle Complete with Part Nos. 26 (Felt Washer), 24-C (Handle Knob), 25 (Handle Knob Rivet), and 28 (Handle Knob Oiler) Standard on Model No. 936	.80
22-EW	Handle Complete with Part Nos. 26 (Felt Washer), 24-C (Handle Knob), 25 (Handle Knob Rivet), and 28 (Handle Knob Oiler) Standard on Model No. 990	1.00